

<b>Team / department</b>	Network Development	<b>Location overview</b>
<b>Reference</b>	60303042	
<b>Location</b>	Throughout Heygate Street	
<b>Proposal</b>	To vary the hours of operation for the existing bus lane from 7am to 7pm every day to 7 to 10am and 4-7pm everyday and shortening the western end by approximately 50m	
<b>Community council meeting</b>	Borough, Bankside & Walworth	
<b>Community council date</b>	23 November 2016	
<b>Ward(s) affected</b>	East Walworth	

### Request

On 15 January 2013 Southwark Council Planning Committee approved the outline planning application number 12/AP/1092 for the redevelopment of the former Heygate Estate including new landscaping, park and public realm, car parking, means of access and other associated works.

The developer subsequently developed the design for the public realm works and this design was submitted to the Planning Committee and approved under planning application 13/AP/3582.

A highways officer has reviewed the proposals and found them to be acceptable from a highway design perspective. In order to implement these changes it is now necessary to make traffic regulation orders.

### Location

Heygate Street is the busiest and main route which bisects the development. It forms part of bus routes 136 and 343.

### Investigation and conclusions

There is currently a bus lane on Heygate St that operates between the hours of 7am and 7pm everyday. This bus lane is intended to provide a way for buses to avoid any traffic queuing back from the signals at Walworth Road. The introduction of a new zebra crossing and a new service access means the western end of the bus lane becomes open to all traffic in any case.

Site monitoring indicates that, outside of the peak hours, long delays at this junction are less of an issue, however drivers are trying to change into the left lane in the short distance between the end of the bus lane and the signals which can result in side-swipe type accidents when traffic is free flowing.

### Recommendation

The bus lane should be shortened to be only as much as will actually operate properly. The hours of operation should be reduced to cover only the hours of operation that they will bring a benefit to the buses; this will be 7-10am and 4-7pm. A detailed drawing of the proposal is provided within this document.

### Next steps

Should the community council approve this traffic order amendment, it is expected that statutory consultation will commence in December.

Should objections be received during the statutory consultation period, these will be presented at the next community council meeting for determination.

Following the statutory consultation period, if no substantive objections are received, the developer will make arrangements to install the described changes, this is likely to take place over the coming year.

APPENDIX 2 HEYGATE ST PROPOSED BUS LANE



Show more on the map  
EXCD\_OutsideOfSouthwark\_mask  
EXCD\_OutsideOfSouthwark\_mask

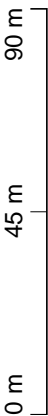
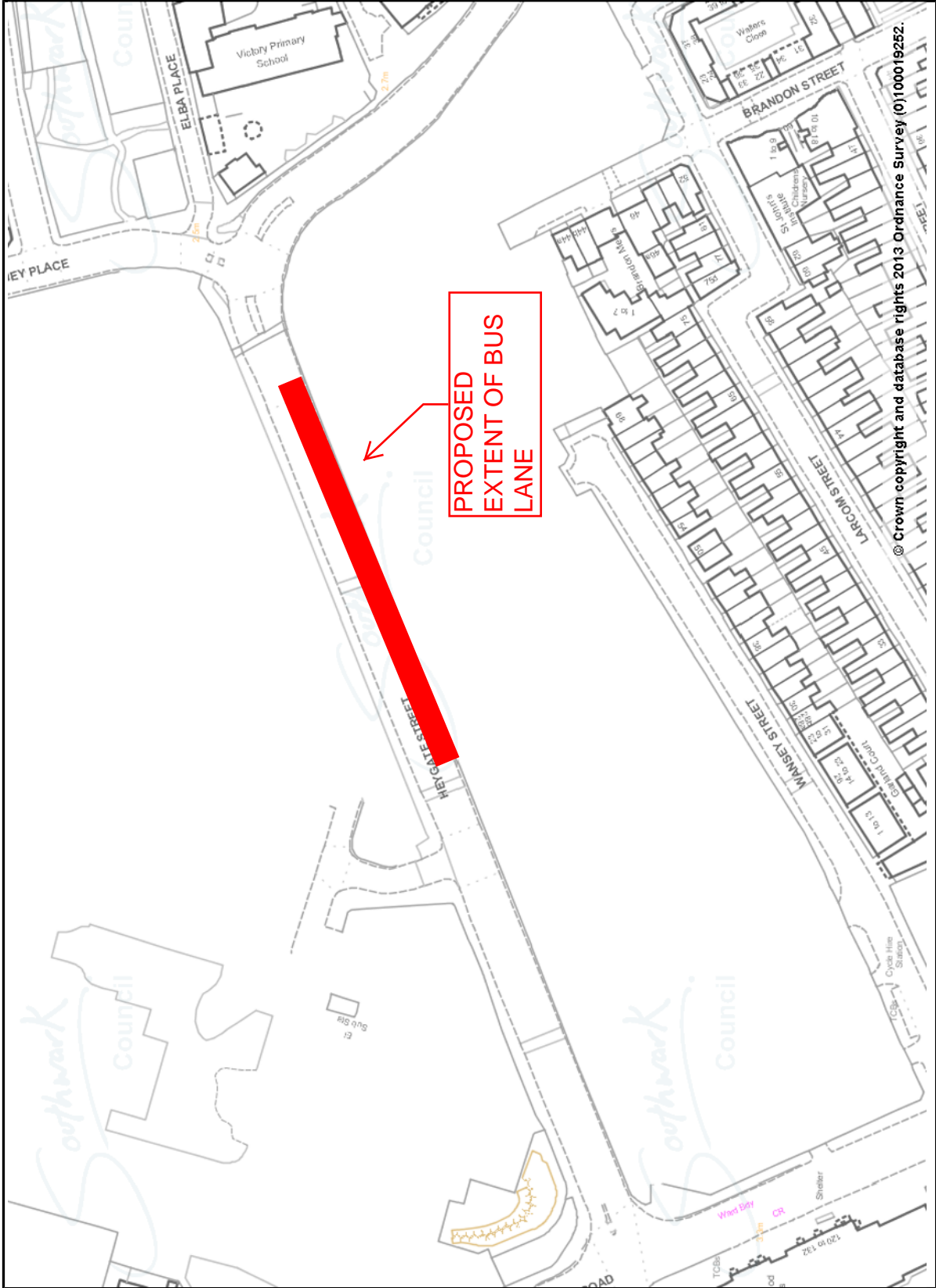

© Crown copyright and database rights 2013 Ordnance Survey (0)100019252.